

INDIAN CREEK

RESIDENCES & YACHT CLUB

A LIMITED COLLECTION *of* NINE
Private WATERFRONT Residences





A PRIVATE RETREAT *Within* An INTERNATIONAL HUB

Located in a lake front corner of Bay Harbor Islands,
Indian Creek Residences & Yacht Club presents the
opportunity for a private waterfront home experience with
the desirable benefits of amenitized new developments.

EXCLUSIVE *Location*

With its perfect combination of bright sunshine, upscale shopping, contemporary architecture, sandy beaches, and a vibrant cosmopolitan culture, Bay Harbor seamlessly connects the international vibrancy of Miami with the undisturbed serenity of Indian Creek Lake

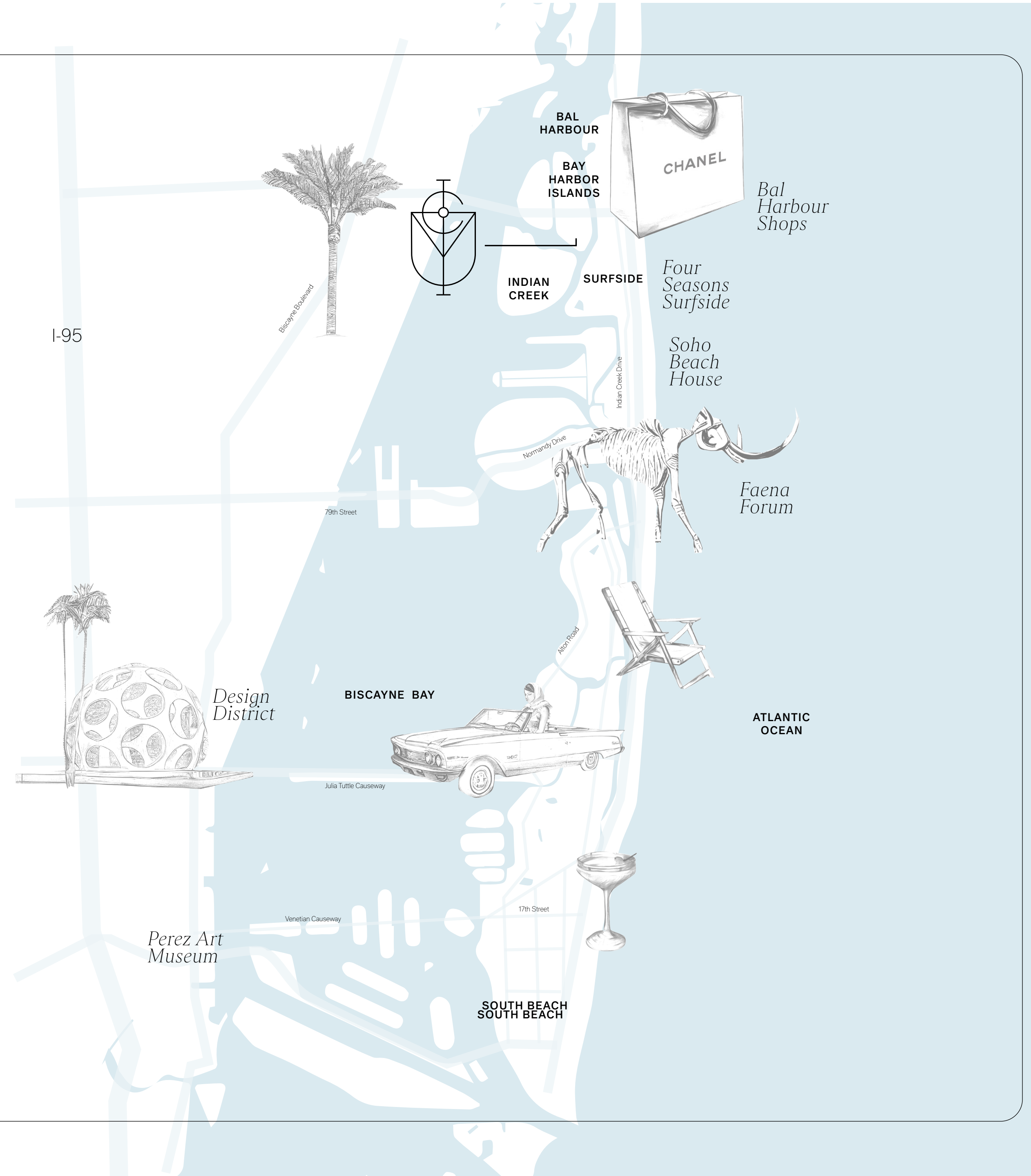

A TEAM OF EXPERTS *Reimagines*
MIMO-MIAMI MODERN *with*
Curved SCULPTURAL *Architecture*
and OPULENT *Materials*

An UNPARALLELED
Level of CUSTOM
DESIGN *Unseen in Miami*

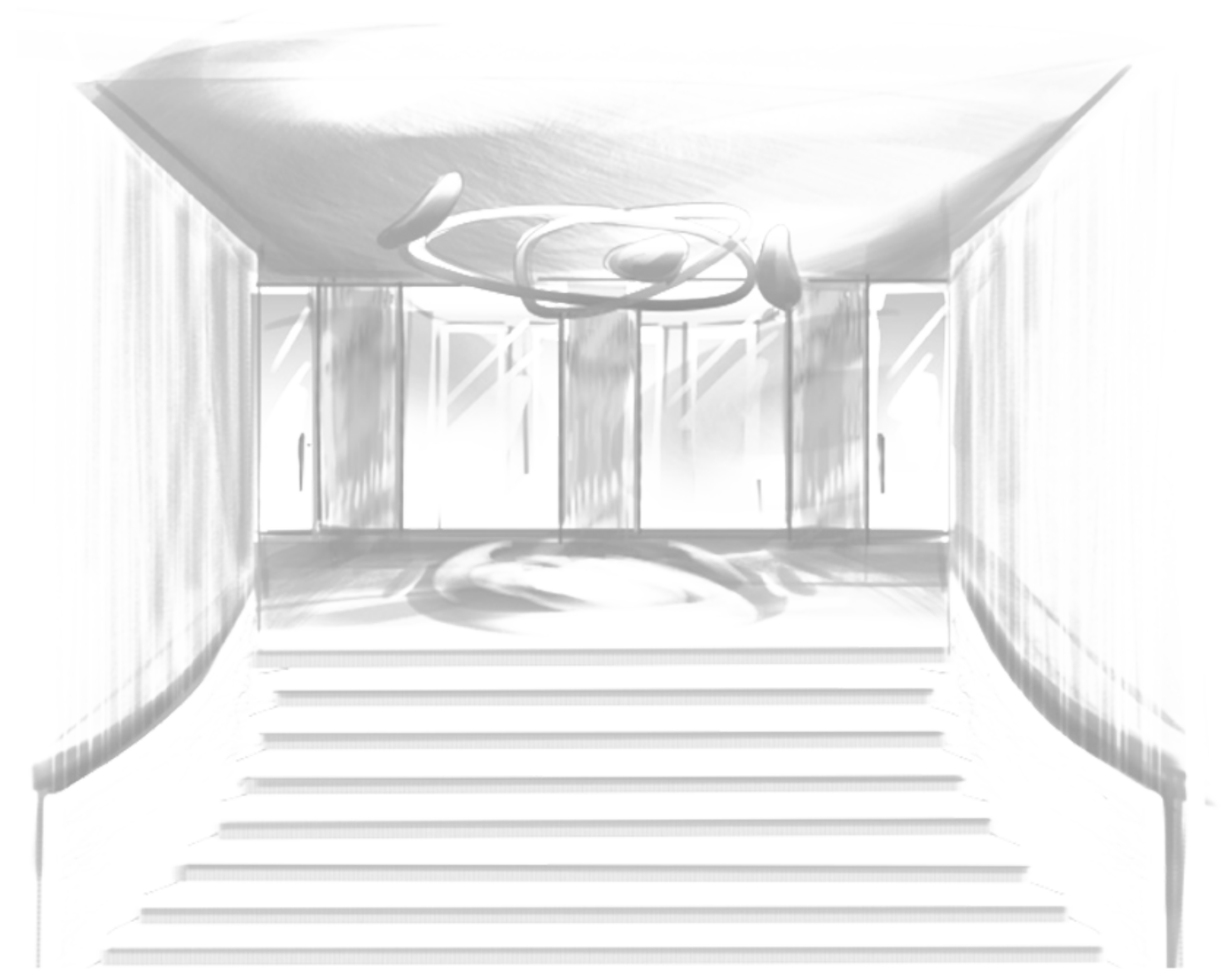

Linda Zanfi



910



LUSH *Tropical*
LANDSCAPE *Design*
Conveys a Resort-Like
RETURN to NATURE



*Full Access to A PRIVATE YACHT CLUB
And STATE-OF-THE-ART AMENITIES
with the SECLUSION of HOME*



CRAFTED *by a* WORLD CLASS *Team*



ZARIFI
Interior Design

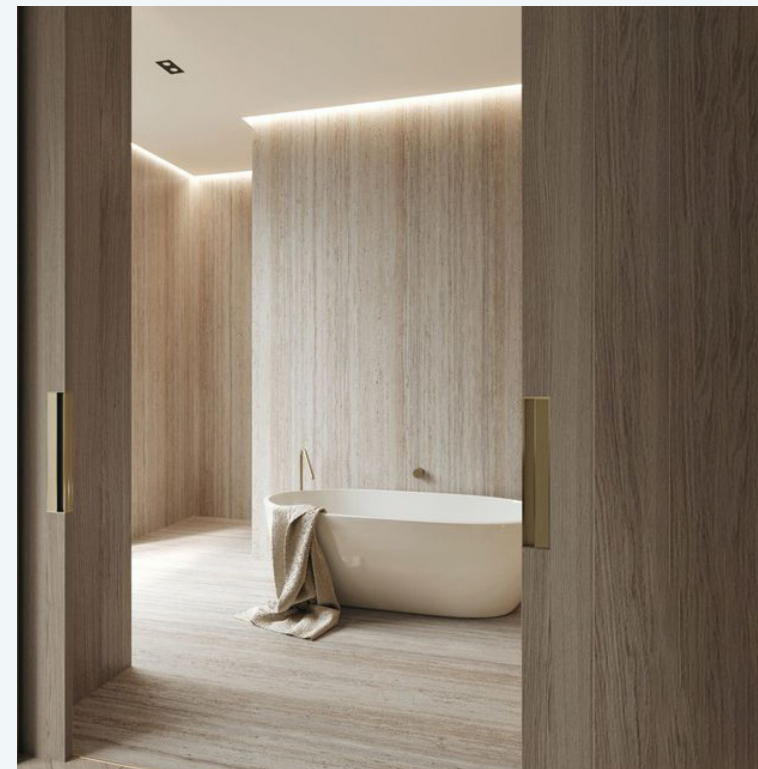

LANDAU
Development



KOBI KARP
Architecture

ENEA
Landscape Design



VENTRESCA
Lighting Design

OCEAN
CONSULTING
Marina Design

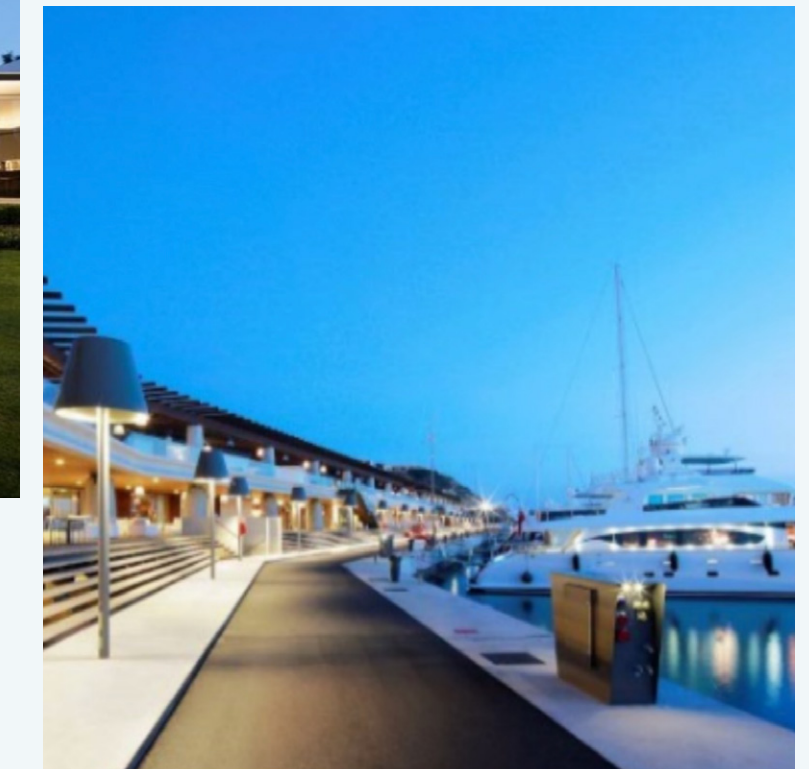

REGISTER *for a* FIRST LOOK

REGISTER



info@indiancreekresidences.com

LANDAU PROPERTIES OFFICIAL

Stated interior square footage is measured to the exterior face of exterior walls and to the centerline of interior demising walls or to the exterior face of walls adjoining corridors or other common elements without excluding areas that may be occupied by columns or other structural components. This method of measurement varies from, and is larger than, the dimensions that would be determined by using the description and the definition of the Unit set forth in the Declaration (which generally only includes the interior airspace between the perimeter walls and excludes structural components). For reference, the area of the unit, determined in accordance with the unit boundaries set forth in the Declaration is set forth in Exhibit "3" to the Declaration. All dimensions are approximate and may vary with actual construction. Note that measurements of rooms set forth on this floor plan are generally taken at the greatest points of each given room (as if the room were a perfect rectangle), without regard for any cutouts or irregularities. Accordingly, the area of the actual room will typically be smaller than the product obtained by multiplying the stated length times width. All floor plans and development plans are subject to change. The Developer expressly reserves the right to make modifications, revisions, and changes it deems desirable in its sole and absolute discretion. All depictions of furnishings, appliances, built-ins, counters, soffits, floor coverings, lighting, landscaping and other matters of detail, including, without limitation, items of finish and decoration, are conceptual only and are not necessarily included in each Unit. Consult your prospectus and Purchase Agreement. Creative by Williams New York.



OPPORTUNITY